

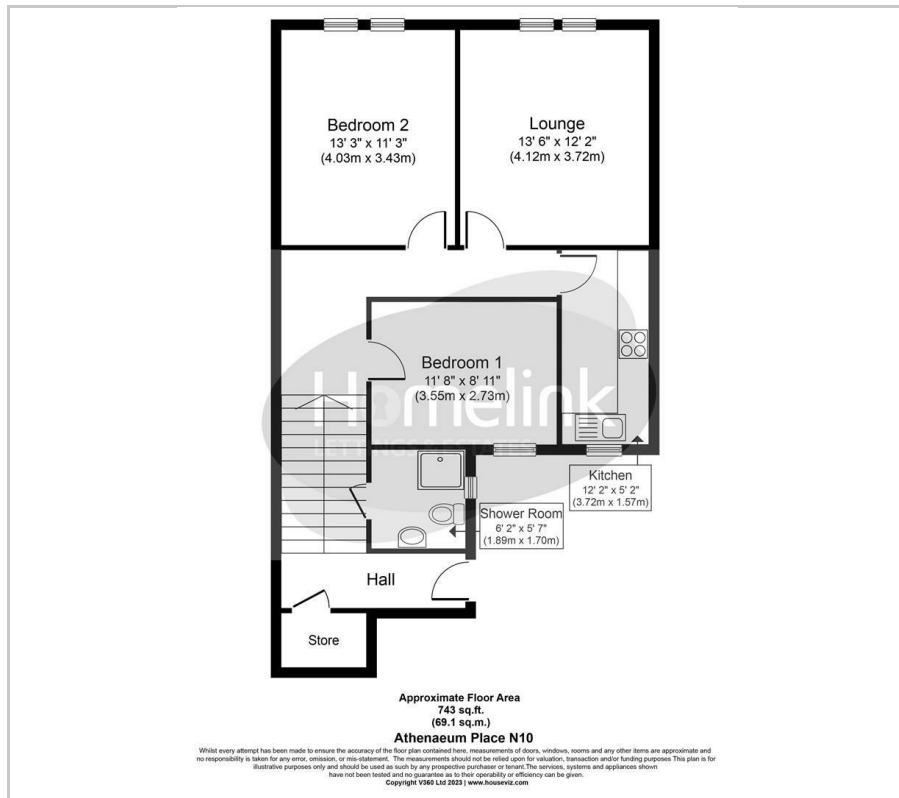

Athenaeum Place, Muswell Hill, N10

£1,800 Per Month

## Floor Plan



## Area Map

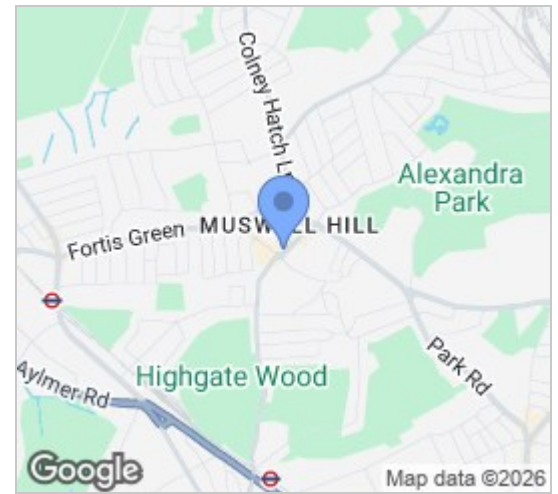

## Energy Efficiency Graph

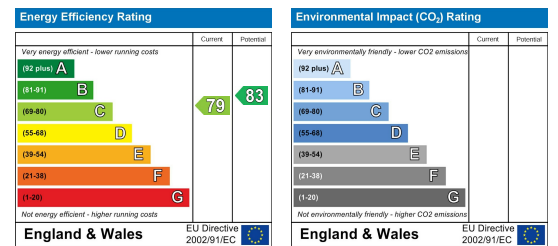

## Viewing

Please contact our Homelink Lettings & Estates Office on 0208 882 2112 if you wish to arrange a viewing appointment for this property or require further information.

- Two bedroom property.
- Fully fitted kitchen.
- Fully tiled shower room.
- Newly laid carpets.
- Centre of Muswell Hill.
- Close to shops.
- Available now.
- Unfurnished.
- Ideal for working professionals.
- Bus routes accessible close by.



**\*\*TWO BEDROOM PROPERTY\*\* \*\*CENTRE OF MUSWELL HILL\*\*** Homelink Lettings & Estates are delighted to offer for rent this well presented two bedroom flat in the heart of the desirable Muswell Hill area. The property benefits from the following, Two large bedroom, large lounge area, full fitted kitchen including white good appliances, gas central heating, double glazed throughout newly laid carpets throughout and is available now on an unfurnished basis.

Great location as the property is based nearby the desirable retails shops and restaurant's. Also various bus routes available towards Highgate, crouch end and Islington. Please call Homelink Lettings & Estates today on 0208 882 2112 and speak with one of our friendly lettings team members.

Council tax amount - B - Haringey Council - £1,717.29



These particulars, whilst believed to be accurate are set out as a general outline only for guidance and do not constitute any part of an offer or contract. Intending purchasers should not rely on them as statements of representation of fact, but must satisfy themselves by inspection or otherwise as to their accuracy. No person in this firm's employment has the authority to make or give any representation or warranty in respect of the property.

Homelink Lettings and Estates  
62 Chase Side, London N14 5PA  
0208 882 2112 [homelink.co.uk](http://homelink.co.uk)

